

CONTRACTORS SHALL VERIFY JOB DIMENSIONS BEFORE ANY JOB COMMENCES. ALL SHOP DRAWINGS SHALL BE SUBMITTED TO THE SUPERINTENDENT AND MANUFACTURERS SHALL NOT COMMENCE FROM THE RETURN OF DIMENSIONS SHOP DRAWINGS ISSUED BY THE CONSULTANT. FIGURED DIMENSIONS SHALL TAKE PRECEDENCE OVER SCALES. THIS DRAWING SHALL BE READ IN CONJUNCTION WITH ALL RELEVANT CONTRACT SPECIFICATIONS AND DRAWINGS COPYRIGHT OF THIS DRAWING IS VESTED IN WARDLE.

General Notes

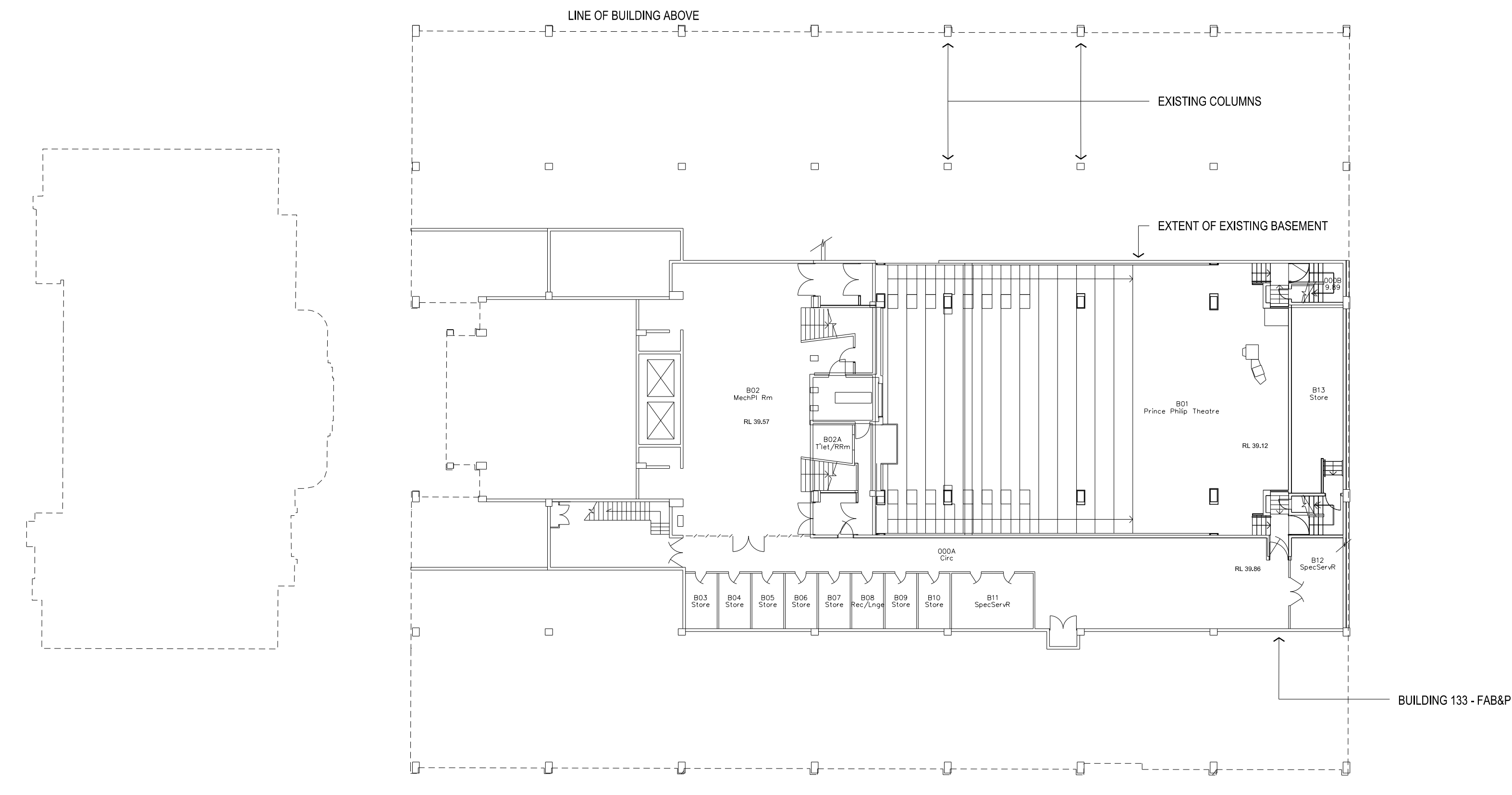

01 EXISTING PLAN
BASEMENT FLOOR PLAN
SCALE 1:200

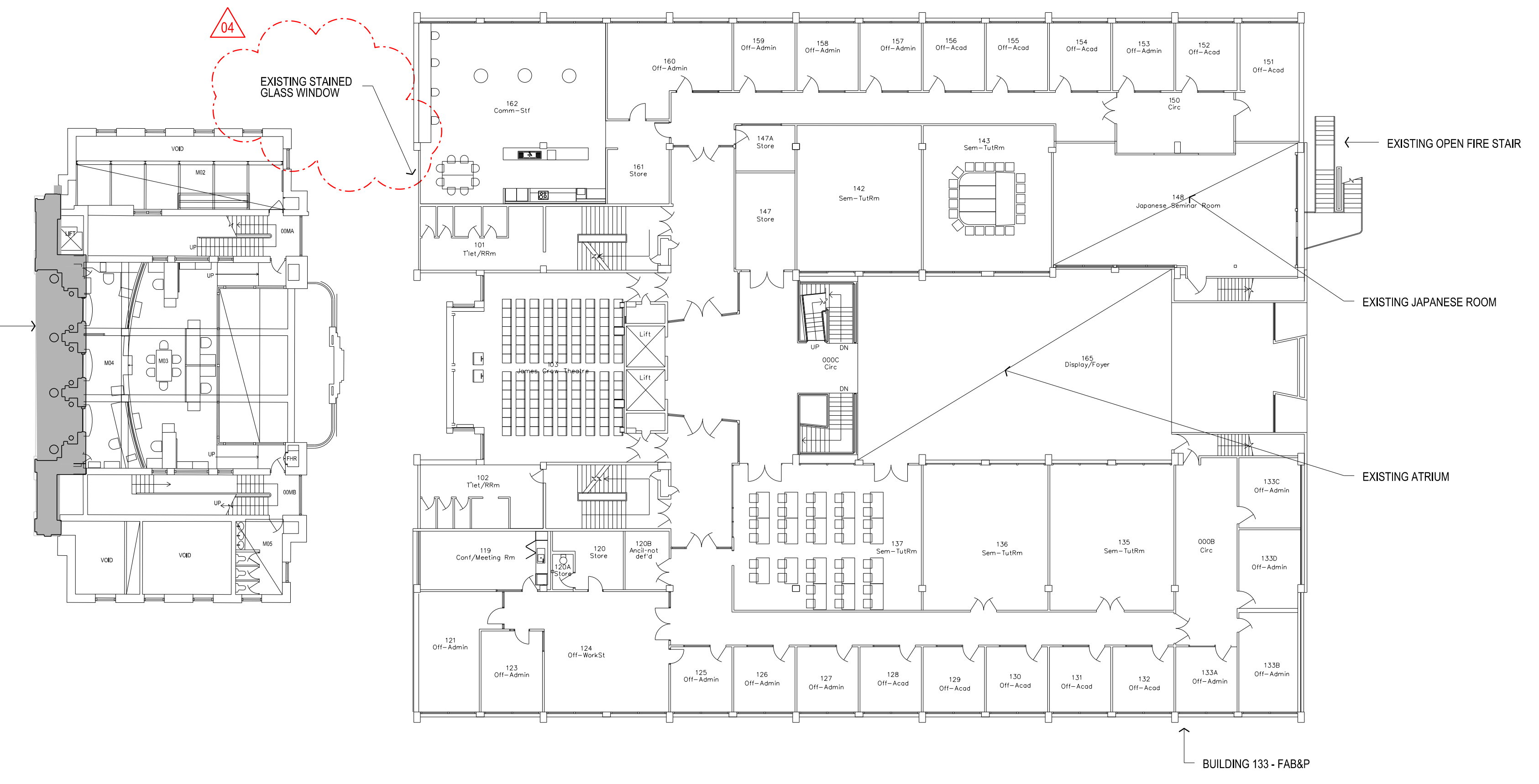

02 EXISTING PLAN
LEVEL 1 FLOOR PLAN
SCALE 1:200

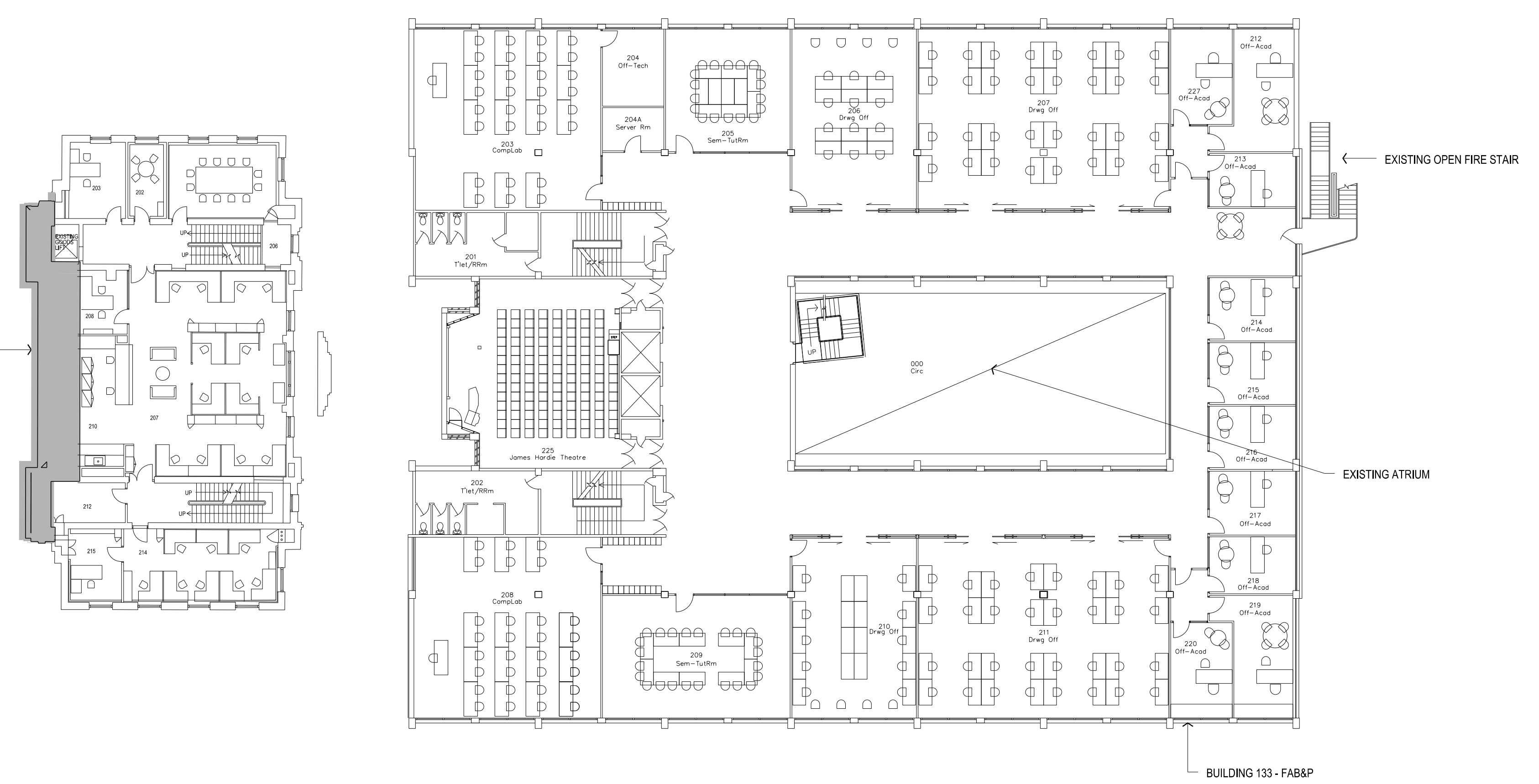

03 EXISTING PLAN
LEVEL 2 FLOOR PLAN
SCALE 1:200

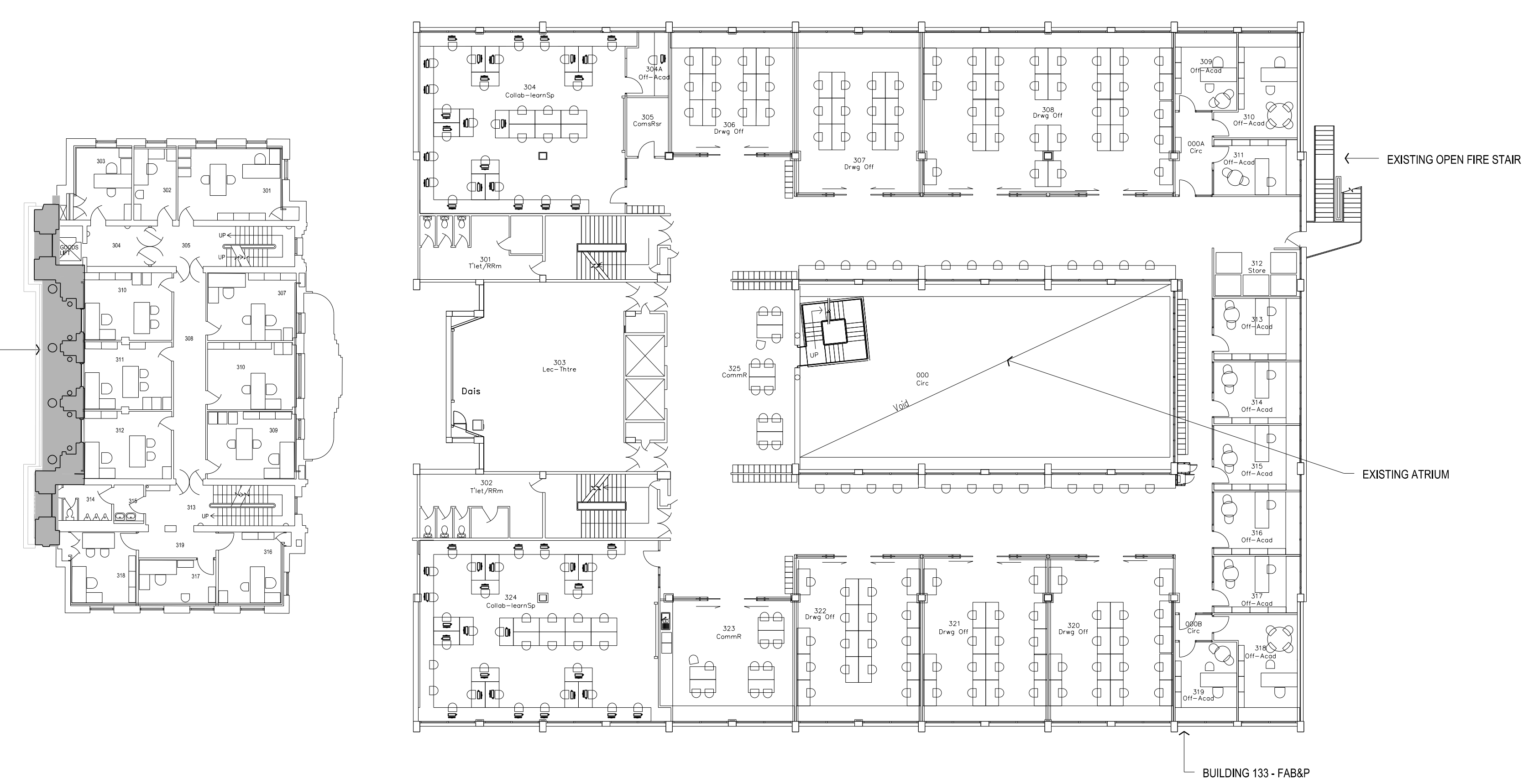

04 EXISTING PLAN
LEVEL 3 FLOOR PLAN
SCALE 1:200

Rev	Issue	Revision Description	And	Date
A	SG	ISSUED FOR CONSTRUCTION	-	10.01.14
09	SG	100% CD - TENDER ISSUE	-	07.08.12
08	SG	FOR TENDER	-	07.08.12
07	SG	100% ENABLING WORKS - DRAWING ISSUE	-	29.05.12
06	1SG	50% CD ISSUE	-	01.05.12
05	SG	50% ENABLING WORKS - DRAWING ISSUE	-	18.05.12
04	SG	25% CD ISSUE	-	20.04.12
03	SG	FINAL DD ISSUE	-	24.02.12
02	SG	DD UPDATE	-	20.01.12
01	SG	DESIGN DEVELOPMENT ISSUE	-	22.12.11



NADAAA
 NADAAA
 1520 Washington Street No.2
 Boston Massachusetts 02115 USA
 Telephone +1 617 442 8232
 Facsimile +1 688 442 1417
 Email nad@nadaaa.com

John Wardle Architects
 25 Rokeby Street, Collingwood, Victoria 3066 Australia
 Tel: +61 3 8662 0400 www.johnwardlearchitects.com
 © 2012 John Wardle Architects ABN 83 006 814 268

Client **University of Melbourne Parkville Campus**

Project **Faculty of Architecture Building and Planning**

Title **Existing Conditions Basement, Level 1, Level 2, Level 3**

Project No.	0913	Scale	1:200 @ A0 1:400 @ A2
Drawing No.	AR0201	Revision	A

Date Dec-2011 Dwn - Co-Ord - Chk -

FILENAME - \$FILES
FOR CONSTRUCTION

